



40 Log Canoe Circle, Stevensville, MD 21666  
(410) 604-3400 | [bardac.com](http://bardac.com) | [driveweb.com](http://driveweb.com)

# Ancillary Guide

Title	PL/X Series Serial Number Locator
Related Products	PL/X Series DC Drives

## Drive Serial Number:

Across all PL/X version 2 drives, the serial numbers can be found on the left side of unit, in the top right corner of the units nameplate. Both version 1 and 2 serial numbers can also be found directly above the drives display on the top horizontal part of the front cover. All serial numbers will be a 4-6 digit number with a barcode above.

## Version 2

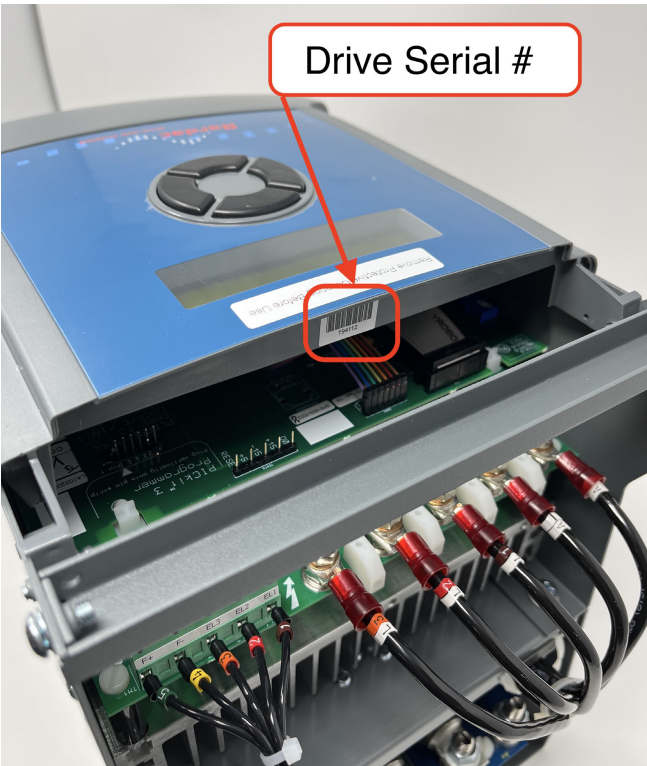

## Version 1



## Control & Power Board Serial Number:

Across all PL/X series drives, the control board serial number can be found directly below terminal 9-12. Terminal block 1-12 will need to be removed to find serial number.

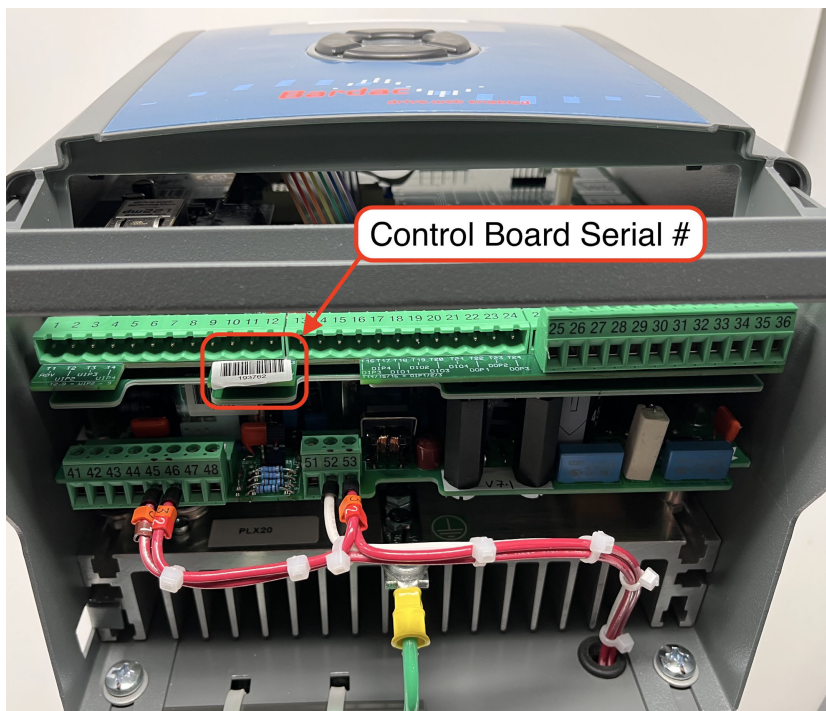

The power board serial number can be found either directly above terminal 47 & 48 attached to the contactor relay, or beside terminal 51-53.

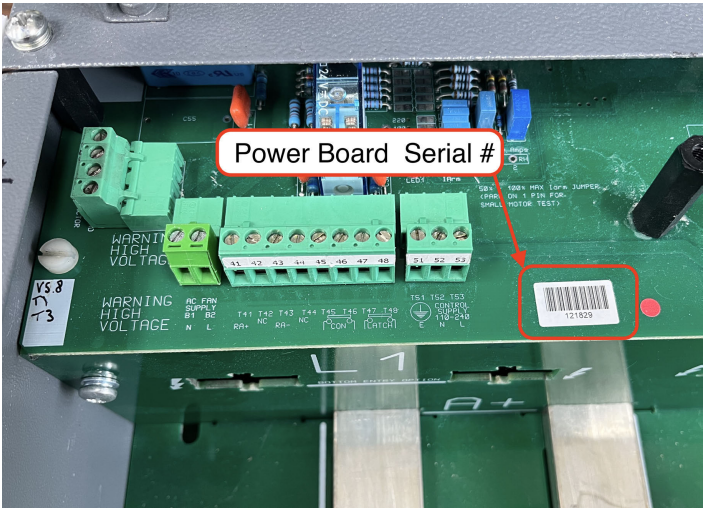
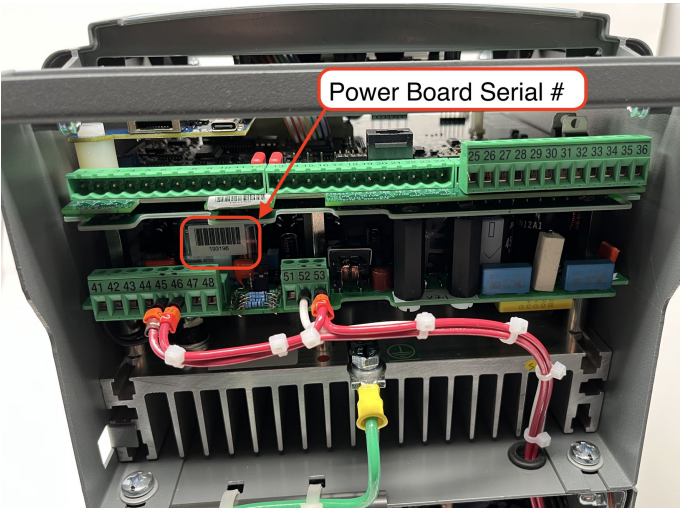

Appendix:

Revision History			
Version	Comments	Author	Date
1	New Document Release	EH	09/25/2025